

BRANNON SUE TRUSTEE
4501 CARDINAL LANE
MIDLAND TX 79707

BY:
Site plan?

PUBLIC NOTICE

The **Planning and Zoning Commission** of the City of Midland, Texas will hold a public hearing at **3:30 p.m.** on **Monday, March 1, 2021**, in the Council Chambers, City Hall, 300 N. Loraine, Midland, TX 79701, and via videoconference on a request by **Landon Torres** for approval of a **Specific Use Designation without Term** on the following described property:

LEGAL DESCRIPTION: On a 0.904-acre tract of land located in Section 5, Block X, HP Hilliard Survey, City and County of Midland, Texas.

LOCATION: Generally located on the north side of W. Loop 250 North, approximately 966 feet west of N. Midkiff Road. (Council District 1)

CURRENT ZONING: RR, Regional Retail District.

SPECIFIC USE: Automobile or other Motorized Vehicle Sales and Services.

I highly object to this zone change!

Not to be considered a part of the Public Notice: 1) See reverse side for location map; 2) In order to be considered as an official objection to this request a response **must be submitted by mail or delivered in writing** to the Planning Division at the address listed above. An official objection may be filed by completing this notice and returning it to the address listed above.

I object to this request ☒ Comments: *We do not need a car dealership on this road or car lot. Existing bldg will not accommodate a service repair department. Land is not large enough for this.*

Required Information:

Sue Brannon
Property Owner's Signature

SUE BRANNON
Printed Name

868 Storage Units
3400 W Loop 250 North
Property Address (No P. O. Boxes)

If any further information is desired, please contact the Planning Division, at 685-7400. Si usted desea más información en Español sobre este caso, llame al: 685-7400

Notices Mailed: 3
Date Mailed: 02/19/2020
Case Number: SUDwo-21-0021
Case Name: 307 Partners, LLC
Planner's Initials: JM *Joseph Main*

Cristina Burns
Cristina Odenborg Burns
Planning Division Manager
Department of Development Services

Mailed Feb 26 2021

The meeting facility is accessible to disabled persons. A wheelchair entry ramp is located at the southeast entrance to City Hall. A parking space designated for use by disabled persons is available near the southeast entrance doors. Any disabled person needing special accommodations or hearing impaired persons wishing to have an interpreter should request services through the Administrative Services Department at least 48 hours prior to the scheduled meeting by contacting Compliance Coordinator for the City of Midland at (432) 685-7251. If communication via TDD is required, please call 1-800-735-2989. Video conference information can be found on the City of Midland's website: <http://www.midlandtexas.gov/9671/PrimeGov-Meetings>

868 Storage Units
Sue Brannon
4501 Cardinal Lane
Midland, Texas 79707

Sole Owner of
868 Storage Units Property
6945588

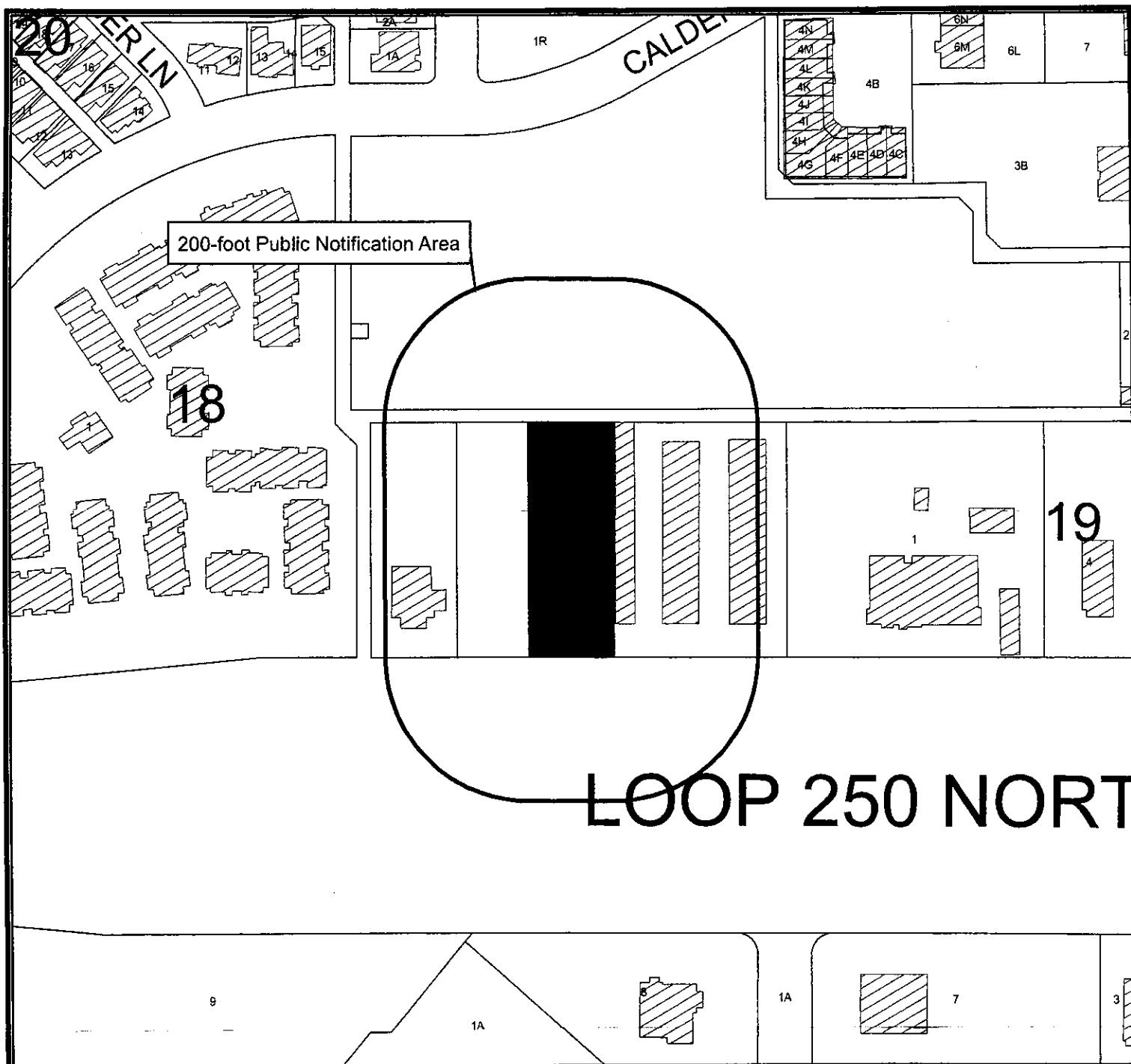

LOCATION MAP

SUDwo-21-0021

Scale: 1" = 200'

Consider a Specific Use Designation without Term for Automobile or other Motorized Vehicle Sales and Services on a 0.904-acre tract of land located in Section 5, Block X, HP Hilliard Survey, City and County of Midland, Texas. (Generally located on the north side of W. Loop 250 North, approximately 966-feet west of N. Midkiff Road. Council District 1)

LEGEND

- CITY LIMITS
- PARCEL
- ▨ PRIVATE BLDGS

